



Metal Hanger

A rod clip ideal for supporting air conditioning line set pairs.



Channel



Rod



Surface

KEY FEATURES

- Fits on both M8 and M10 studding
- Zinc passivated to resist corrosion
- Rapid 2 pipe installation
- Ideal for when you need to meet fire regulations
- Avoids the need for cable trays

SPECIFICATIONS

Materials of construction	Zinc passivated mild steel
Max. temp	1000°C
Max. rec. distance per clip	1.2m

SIZING OPTIONS

Description	Liquid*	Gas*	Part No.	Pack Qty
2	3/8"	5/8"	B6492	10
3	1/2"	7/8"	B6493	10
4	5/8"	1 1/8"	B6494	10

* Approximate pipe sizes (allowing for insulation)



Material: BS EN 10230:2006. Coating: BS EN 12329:2000



For further details please refer to our website aspenspumps.com

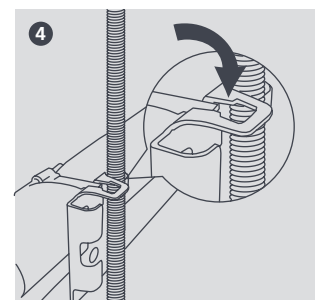
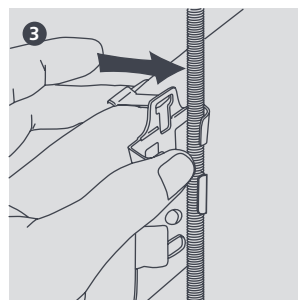
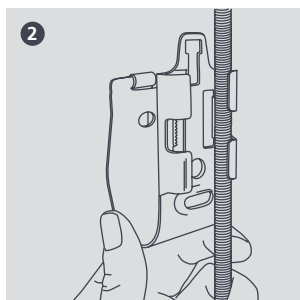
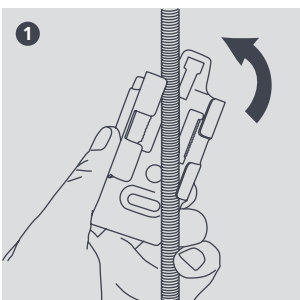

Information correct at time of going to press.