

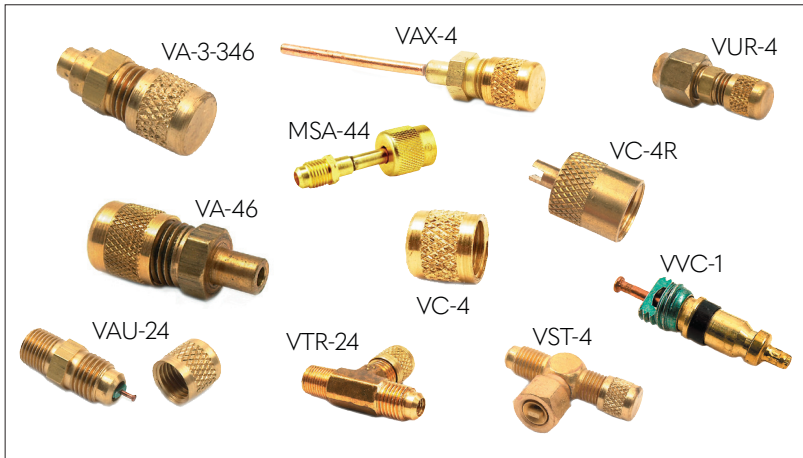

ACCESS FITTINGS



Time is money, and the DiversiTech range of access valves and fittings are designed for quick and easy installation on either OEM equipment or for refrigeration servicing. They can be installed anywhere, on either the high or low side for charging, purging, quick testing, or pressure checking.

The DiversiTech access fittings have a 1/4" SAE male flare access ports, and include a quick seal cap, in addition to a stainless steel and brass Schrader core fitted.

Code	Description	Size (inches)	Pack QTY
VA-3-346	3-Way Solder Fitting	3/16 OD to 1/4 & 3/8	6
VA-34	Straight Solder Fitting	3/16 ODS x 1/4 ODF	6
VA-46	Straight Solder Fitting	1/4 ODS x 3/8 ODF	6
VA-68	Straight Solder Fitting	3/8 ODS x 1/2 ODF	6
VAU-24	Half Union	1/8 MPT	6
VAU-45	Half Union	1/4 MPT	6
VAX-3	Extended Copper Tube Fitting	1/4 SAE Flare with 3/16 OD x 1/8 ID with 2inch tail	6
VAX-4	Extended Copper Tube Fitting	1/4 SAE Flare with 1/4 OD x 3/16 ID with 2inch tail	6
VAX-4B	Extended Copper Tube Fitting	1/4 SAE Flare with 1/4 OD x 3/16 ID with 2inch tail	100
VAX-4B-6	Extended Copper Tube Fitting	1/4 SAE Flare with 1/4 OD x 3/16 ID with 6inch tail	1
VAX-5	Extended Copper Tube Fitting	1/4 SAE Flare with 5/16 OD x 1/4 ID with 2inch tail	3
VAX-5-PH	Extended Copper Tube Fitting	5/16 SAE Flare (R410a) with 1/4 OD x 3/16 ID with 2inch tail	1
VAX-6	Extended Copper Tube Fitting	1/4 SAE Flare with 3/8 OD x 5/16 ID with 2inch tail	3
VC-4	SAE Flare Cap 1/4	Plain Cap	12
VC-4R	SAE Flare Cap 1/4	Cap with Core Remover	12
VS-4	Access Fitting - Female Flare	Female 1/4 SAE Swivel Nut w /Depressor x 1/4 SAE male flare	3
VST-4	Swivel Tee 1/4	1/4 SAE Flare x 1/4 SAE Flare on run x 1/4 Female Swivel on branch	3
VST-44	Swivel Tee 1/4	1/4 SAE Flare x 1/4 Female Swivel on run x 1/4 SAE Flare on branch	3
VST-4X	Swivel Tee 1/4 with depressor	1/4 SAE Flare x 1/4 SAE Flare on run x 1/4 Female Swivel on branch	3
VST-44X	Swivel Tee 1/4 with depressor	1/4 SAE Flare x 1/4 Female Swivel on run x 1/4 SAE Flare on branch	3
VTR-24	Threaded Tee Fitting	1/8 MPT x 1/4 Male SAE Flare on run x 1/4 SAE Male Flare on branch	3
VTS-10	Solder Tee Fitting	5/8 ODS x 5/8 ODS on run with 1/4 SAE Male Flare on branch	3
VTS-46	Solder Tee Fitting	1/4 ODS x 1/4 ODS on run with 1/4 SAE Male Flare on branch	3
VTS-68	Solder Tee Fitting	3/8 ODS x 3/8 ODS on run with 1/4 SAE Male Flare on branch	3
VTS-810	Solder Tee Fitting	1/2 ODS x 1/2 ODS on run with 1/4 SAE Male Flare on branch	3
VUR-4	Full Union	1/4 OD SAE Flare x 1/4 SAE Flare with Cap	6
MSA-44	Adaptor - SAE Female to MNPT	1/4 SAE Female Swivel x 1/4 MNPT	2
VVC-1	Replacement Valve Core Tool		6
VCR-1	Core Removal Tool & Storer		1
VCR-T1	Core Removal Tool		1

FITTINGS ACCESS FITTINGS

The DiversiTech International sales team are available to answer your questions or queries on this product. Our experts are waiting for your call +44 (0)115 900 5858 or if you prefer send an email to sales@diversitech.com or visit www.diversitech.global



TECHNICAL SPECIFICATION

Part code	Description	Dimensions	Temperature range	Max working pressure	Weight
VA-3-346	3-Way solder type for 3/16" OD tube or 1/4" and 3/8" solder fitting	A - 1.0" B - 0.25" C - 0.50" D - 0.15" E - 0.19"	30°F -400°F	500PSI	0.27 lbs
VA-34	Straight solder type for 3/16" ODS x 1/4" ODF	3/16" ODS x 1/4" ODF	30°F -400°F	500PSI	0.2 lbs
VA-46	Straight solder type for 1/4" ODS x 3/8" ODF	1/4" ODS x 3/8" ODF	30°F -400°F	500PSI	0.2 lbs
VA-68	Straight solder type for 3/8" ODS x 1/2" ODF	3/8" ODS x 1/2" ODF	30°F -400°F	500PSI	0.2 lbs
VAU-24	Half union 1/8"	A - 1.06" B - 0.30" C - 0.50" D - 0.19" E - 0.25"	30°F -400°F	500PSI	0.2 lbs
VAU-45	Half union 1/4"	A - 1.27" B - 0.40" C - 0.50" D - 0.27" E - 0.313"	30°F -400°F	500PSI	0.430 lbs
VAX-3	Extended copper tube 3/16" OD x 1/8" ID	A - 0.952" B - 0.388" C - 0.58" D - 0.18" E - 0.188"	30°F -400°F	500PSI	0.354 lbs
VAX-4	Extended copper tube 1/4" OD x 3/16" ID	A - 0.952" B - 0.40" C - 0.58" D - 0.18" E - 0.188"	30°F -400°F	500PSI	0.364 lbs
VAX-4B	Extended copper tube connection 6.35mm OD x 4.76mm ID	A - 0.952" B - 0.40" C - 0.58" D - 0.18" E - 0.188"	30°F -400°F	500PSI	0.0640 lbs
VAX-4B-6	Extended copper tube 3/16" OD x 1/8" ID with 6" tail	A - 0.952" B - 0.388" C - 0.58" D - 0.18" E - 0.188"	30°F -400°F	500PSI	0.430 lbs
VAX-5	Extended copper tube 5/16" OD x 1/4" ID	A - 0.952" B - 0.423" C - 0.58" D - 0.18" E - 0.188"	30°F -400°F	500PSI	0.2 lbs
VAX-5-PH	Extended copper tube 5/16" OD x 1/4" ID (R410A)	A - 0.952" B - 0.423" C - 0.58" D - 0.18" E - 0.188"	30°F -400°F	500PSI	0.2 lbs
VAX-6	Extended copper tube 3/8" OD x 5/16" ID	A - 1.0" B - 0.495" C - 0.529" D - 0.283" E - 0.188"	30°F -400°F	500PSI	0.236 lbs

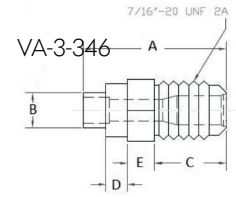

VAU-24 / VAU-45

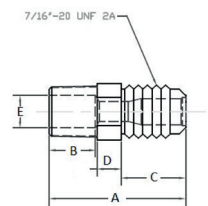

VAX-3 / 4 / 4B / 4B-6 / 5 / 5-PH / 6

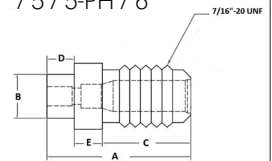



TECHNICAL SPECIFICATION

Part code	Description	Dimensions	Temperature range	Max working pressure	Weight
VC-4	Flare cap for 1/4"	A - 0.54" B - 0.118" C - 0.118"	30°F -400°F	500PSI	0.228 lbs
VC-4R	SAE flare cap with core removal for 1/4"	A - 0.54" B - 0.118" C - 0.118" D - 0.217" E - 0.175"	30°F -400°F	500PSI	0.2 lbs
VS-4	Swivel nut with depressor for 1/4" female flare fired swivel nut	A - 1.76" B - 0.58" C - 0.50"	30°F -400°F	500PSI	0.510 lbs
VST-4	Swivel tee with permanent depressor for 1/4" access on run x 1/4" female flare with depressor on female swivel branch end	A - 1.658" B - 1.17" C - 0.25"	30°F -400°F	500PSI	0.378 lbs
VST-44	Swivel tee with permanent depressor 1/4" access on run x 1/4" access on T - female swivel on run	A - 2.30" B - 0.50" C - 0.50" D - 0.63" E - 1.21"	30°F -400°F	500PSI	0.402 lbs
VST-4X	Swivel Tee 1/4 with depressor		30°F -400°F	500PSI	0.430 lbs
VST-44X	Swivel Tee 1/4 with depressor		30°F -400°F	500PSI	0.430 lbs
VTR-24	Threaded tee for 1/8" MPT x 1/4" male flare on run x access on branch	A - 1.67" B - 0.88" C - 0.875"	30°F -400°F	500PSI	0.2 lbs
VTS-10	Solder tee type for 5/8" OD tube	A - 2.00" B - 1.19" C - 0.631"	30°F -400°F	500PSI	0.2 lbs

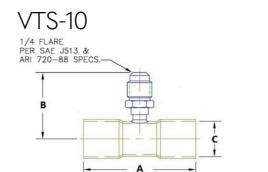
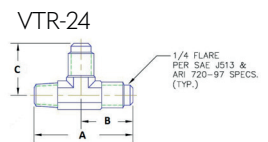
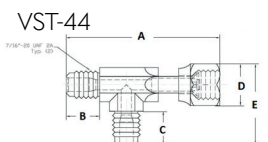
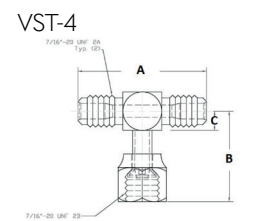
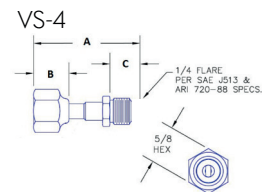
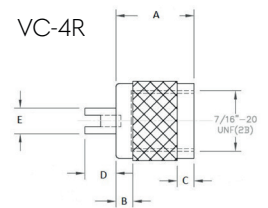
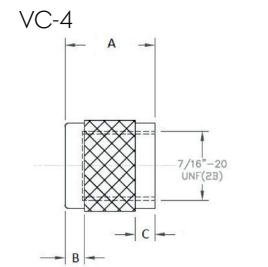

FITTINGS ACCESS FITTINGS

The DiversiTech International sales team are available to answer your questions or queries on this product. Our experts are waiting for your call +44 (0)115 900 5858 or if you prefer send an email to sales@diversitech.com or visit www.diversitech.global



TECHNICAL SPECIFICATION

Part code	Description	Dimensions	Temperature range	Max working pressure	Weight
VTS-46	Solder tee type for 1/4" ODS x 5/16" ODF	A - 2.31" B - 1.00" C - 0.256"	30°F -400°F	500PSI	0.178 lbs
VTS-68	Solder tee type for 3/8" ODS	A - 2.36" B - 1.06" C - 0.50" D - 0.12" E - 0.12"	30°F -400°F	500PSI	0.2 lbs
VTS-810	Solder tee type for 1/2" ODS	A - 2.00" B - 1.13" C - 0.506"	30°F -400°F	500PSI	0.216 lbs
VUR-4	Full Union	1/4" OD	30°F -400°F	500PSI	0.430 lbs
MSA-44	Adaptor - SAE Female to MNPT		30°F -400°F	500PSI	0.430 lbs
VVC-1	Replacement Valve Core Tool		30°F -400°F	500PSI	0.430 lbs
VCR-1	Core Removal Tool & Storer		30°F -400°F	500PSI	0.430 lbs
VCR-T-1	Core Removal Tool		30°F -400°F	500PSI	0.430 lbs

VTS-46

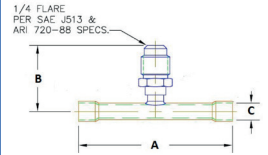

VTS-68

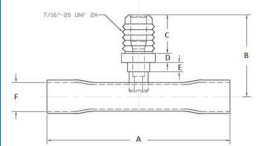

VTS-810

